



16/1000 Mbps

18 Port PoE

PLN-1116GB



Pollo Pty Ltd.

Address: Suite 401, 55 Phillips St. Parramatta, NSW 2150

Phone: 1300 6600 368

Email: info@pollo.net.au

Website: www.pollo.net.au



16/1000 Mbps

18 Port PoE

PLN-1116GB



Overview:

The **PLN-1116GB** is a full gigabit unmanaged PoE switch independently developed by POLLO. It has 16*10/100/1000Base-T PoE ports and 2*10/100/1000Base-T uplink RJ45 ports. Port 1-16 can support IEEE802.3af/at PoE standard. Single-port PoE power up to 30W. As a PoE power supply device, it can automatically detect and recognize the power receiving equipment that meets the standard and supply power through the network cable. It can supply power to POE terminal equipment such as wireless AP, webcam, VoIP phone, video access control intercom, etc. through a network cable to meet the network environment that needs a high-density PoE power supply. It is suitable for hotels, campuses, factory quarters, and small and medium-sized enterprises to form an economy efficient network.

Unmanaged model, plug and play, no configuration, easy to use.

FEATURES:

Full gigabit access

- ✔ Support non-blocking wire-speed forwarding.
- ✔ Support full-duplex based on IEEE802.3x and half-duplex based on Backpressure.
- ✔ Provide Gigabit Ethernet ports and dual RJ45 ports uplink for flexible networking and meets the networking requirements of various scenarios.

Intelligent PoE power supply

- ✔ IEEE802.3af/at PoE standard, without damaging non-PoE devices.
- ✔ Priority system for PoE port, it will supply power to the high priority level port first when the power budget is insufficient and avoid overwork of the device.
- ✔ 16*10/100/1000Base-T RJ45 ports, meeting the needs of security monitoring, teleconferencing system, wireless coverage, and other scenarios.

Stable and reliable, easy to use

- ✔ CCC, CE, FCC, RoHS.
- ✔ Plug and play, no configuration, simple and convenient.
- ✔ Low power consumption, galvanized steel casing, no fan.
- ✔ The user-friendly panel, it can show the device status through the LED indicator of PWR, Link/Act,

PoE.

- Self-developed power supply, high redundancy design, providing a long term and stable PoE power output.

DIMENSION

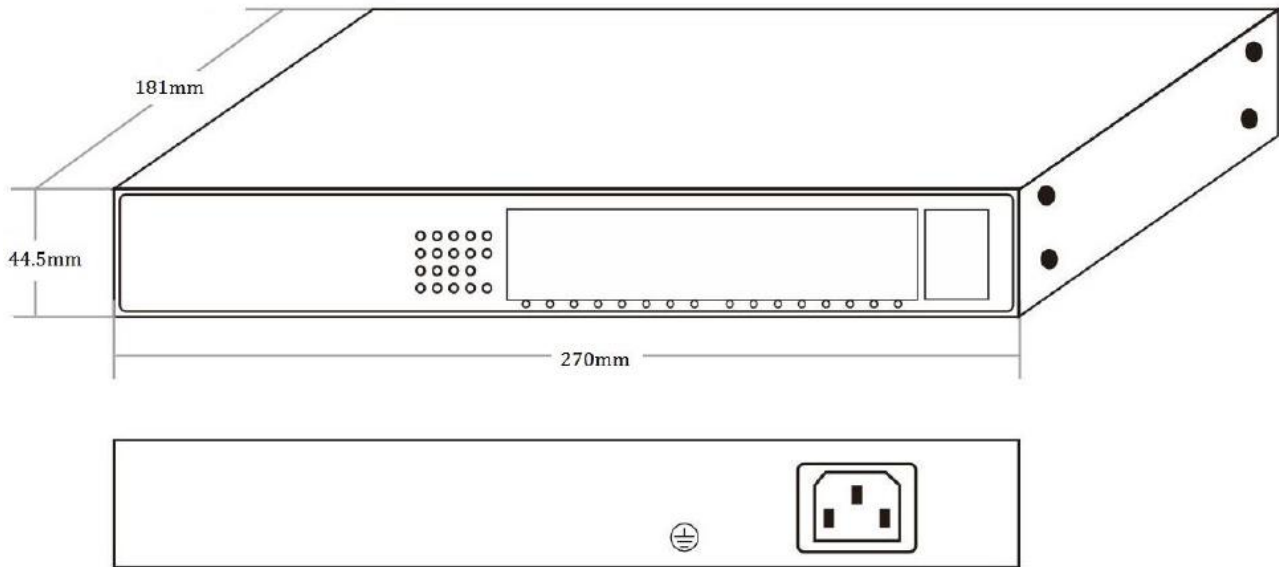

APPLICATION

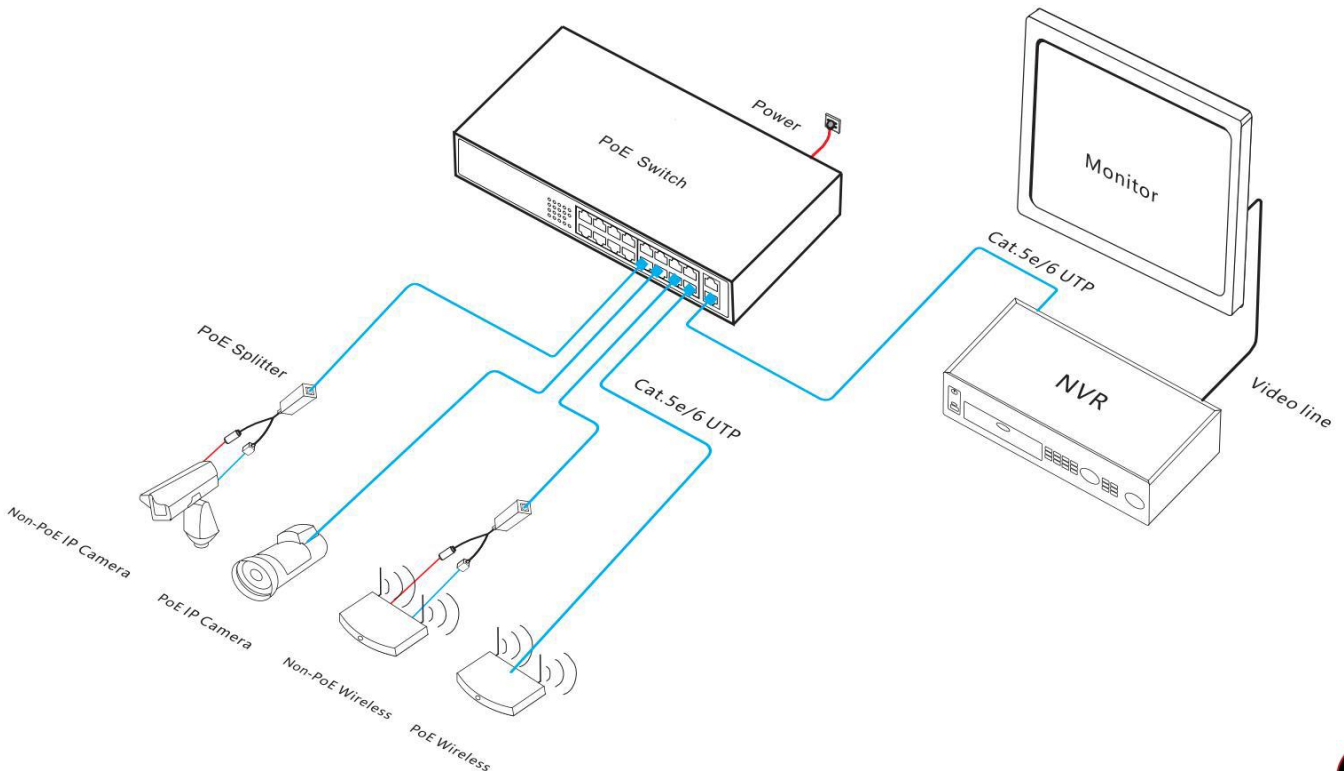

TECHNICAL SPECIFICATION

Model	PLC-1116GB
Fixed Port	16*10/100/1000Base-T PoE ports (Data/Power) 2*10/100/1000Base-T uplink RJ45 ports (Data)
Ethernet Port	Port 1-16 support 10/100/1000Base-T autosensing, full/half duplex MDI/MDI-X self-adaption
Twisted Pair	10BASE-T: Cat3, 4, 5 UTP (≤100 meters)
Transmission	100BASE-TX: Cat5 or later UTP (≤100 meters) 1000BASE-T: Cat5e or later UTP (≤100 meters)
Network Protocol	IEEE802.3 10BASE-T, IEEE802.3i 10Base-T IEEE802.3u 100Base-TX, IEEE802.3ab 1000Base-T, IEEE802.3x
Forwarding Mode	Store and Forward (Full Wire Speed)
Switching Capacity	36Gbps (non-blocking)
Forwarding Rate@64byte	26.78Mpps
MAC	2K
Buffer Memory	2M
Jumbo Frame	9.2k
LED Indicator	Power: PWR (Green), Network: Link (Green), PoE: PoE (Green)
PoE Port	Port 1 to 16
Power Supply Pin	1/2(+) 3/6(-)
Max Power Per Port	30W, IEEE802.3af/at
Total PWR / Input Voltage	160W/ (AC100-240V)
Power Consumption	Standby <13W, Full load <160W
Power Supply	Built-in power supply, AC100~240V 50-60Hz 4.1A
Operation TEMP /Humidity	-20~+55°C, 5%~90% RH Noncondensing
Storage TEMP /Humidity	-40~+75°C, 5%~95% RH Noncondensing
Dimension (L*W*H)	270*181*44.5mm
Net /Gross Weight	<1.25kg / <1.6kg
Installation	Desktop, 19-inch 1U cabinet
Lightning Protection	Lightning protection: 4KV 8/20us, Protection level: IP30
Certification	CCC, CE mark, commercial, CE/LVD EN62368-1, FCC Part 15 Class B, RoHS