

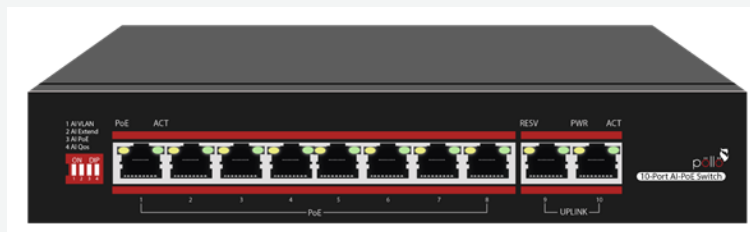

10 Port 10/100Mbps AI PoE switch PLN-1108MB



Pollo Pty Ltd.

Address: Suite 401, 55 Phillips St. Parramatta, NSW 2150

Phone: 1300 6600 368

Email: info@pollo.net.au

Website: www.pollo.net.au





10 Port 10/100Mbps AI PoE switch (PLN-1108MB)

Fast Ethernet Artificial Intelligence PoE Switch

- ✦ CCTV Extend: 1-8 port supports 250M meters long distance power supply (recommended cat 5 or above)
- ✦ **VLAN:** Isolating ports 1-8 from each other, restrain network storms effectively and improve network performance
- ✦ **AI QOS:** Prioritize the identified video data to make video transmission smoother
- ✦ **AI Poe:** Automatic detection power of port, power off and restart the device if find dead machine
- ✦ Support wireless access points (APs) and network surveillance cameras via Cat 5 cables;
- ✦ Support IEEE802.3af/at standard PD device ;
- ✦ Support Auto MDI/MDIX;
- ✦ Adopt store-and-forward exchange method
- ✦ Intelligent power supply, the lowest power consumption, ensure PD power needs
With power circuit protection, protect the safety of PD
- ✦ Zero configuration feature power is automatically supplied to the adaptive device;
- ✦ Fanless design, energy saving and environmental protection; no noise, reduce the impact on the environment
- ✦ Support port without link power saving function

Description

PLN-1108MB is a 10-port built-in power 10/100Mbps PoE switch. It has 4 working modes, VLAN mode, CCTV extend mode, AI POE mode, QOS mode. All ports are free to communicate by default; In VLAN mode, 1 -8ports are isolated from each other, which can effectively restrain network storms and improve network performance. In CCTV Extend mode, the effective transmission distance of 1-8 ports can reach 250 meters, which is suitable for remote monitoring and power supply. In the AI POE mode, the switch automatically detects the working status of the PD device and finds that the device abnormal automatically restarts the device. In QOS mode: the video data will be processed

preferentially when the device is congested to make the video smoother. The device supports IEEE 802 af/at standard, which can automatically detect and identify the PDs that comply with the IEEE 802 af/at standard and provide power for them, so there is no need to worry about PoE or non-PoE devices that can damage private standards.

Technical Specification

Product Name	10 Port 10/100Mbps AI PoE switch
Product Model	PLN-1108MB
Connector	8x 10/100M RJ45 Ports (MDI/MDIX auto sensing) Max PoE power output is 30W. Total: 96W Transmission Distance: 250 Meters @10M, 100 Meters @ 100M
Transfer Mode	Store-And-Forward
Network Medium	Twisted Pair
Performance Specification	Bandwidth: 2.0Gbps Network latency (100 to 100M bps) : maximum 20 μs (using 64 byte packet) Buffer Memory:1Mbit MAC Size: 2K MTBF: 50,000hours
Network Protocols and Standards	AI VLAN AIPoE AI EXTEND AI Qos
Switch Mode Definition	Mode 1: Port 1-6: 10/100 autosensing. @100meters. Mode 2: Port 1-4: 10M @ 250 meters
LEDs Status	PWR RESV L/A PoE Indicator
Power	Total Power : 96W Single Port : 30W
Dimension	210 * 152 * 40mm
Working Environment	Operating Temperature: 0 ° ~ 40 ° C; Storage Temperature: -40 ° ~ 70 ° C; Humidity: 10% ~ 90%, non condensing Storage Humidity: 5% ~ 90%, non-condensing; Working Altitude: 3000 m (10,000 ft); Storage Altitude: 3,000 m (10,000 ft)
Radiation	CE FCC FCCI Class A
Safety	CE/ROHS/FCC/CCCC
Warranty	1 year warranty

Dimensions

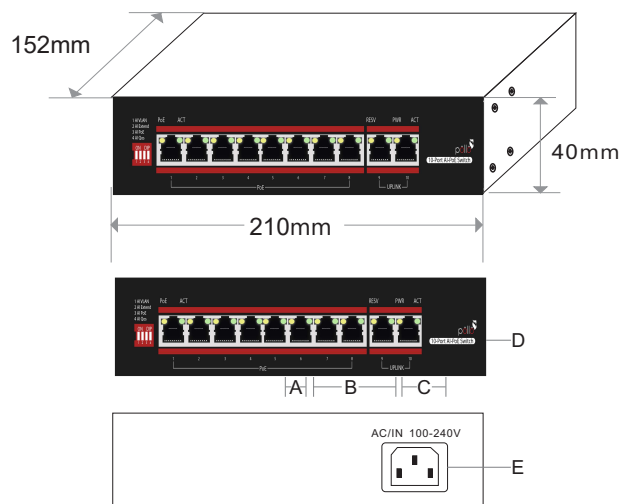

- A. Working Indicator B. 8x 100M PoE Ports
 C. 2x100Mbps Uplink Port D. Switch (Standard: 100m ; Extend: 250 m)
 E. AC100-240V,50/60Hz

Application

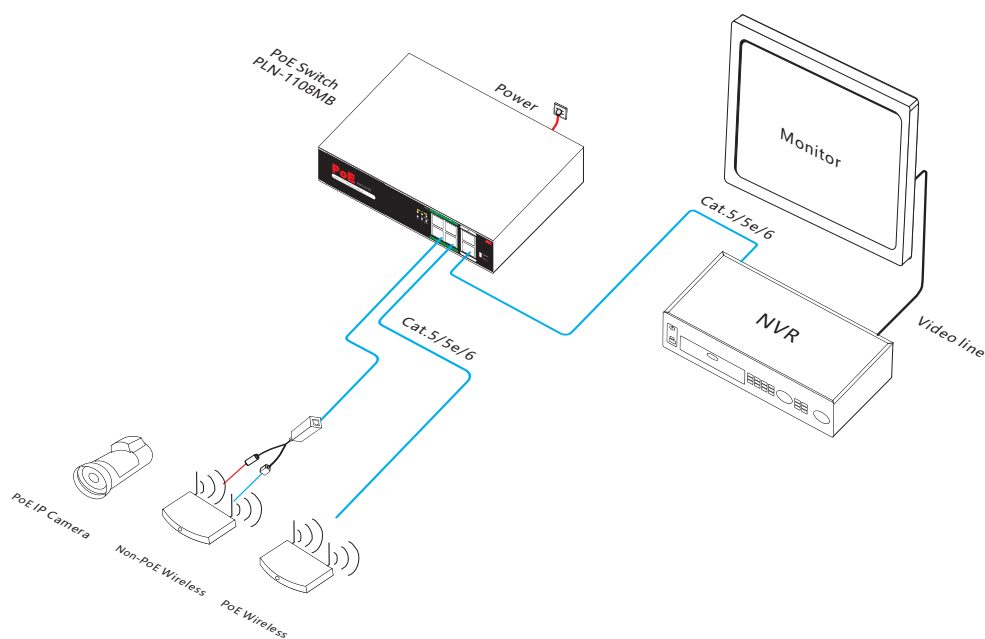

Ordering Information

Product Model: PLN1108MB

Product Description: 10-Port 10/100M Artificial Intelligence PoE Switch. Port 1-8support PoE function with port isolation function. IEEE802.3af/at, max PoE power output for each port is 30W. Total power is 96W. Long transmission distance at 250 meters for both power and data. Built-in power supply.

Packing List

Packing List	10 Port 10/100Mbps AI PoE switch
	Power Cable
	Mounting Kits
	User Guide
	Warranty Card