

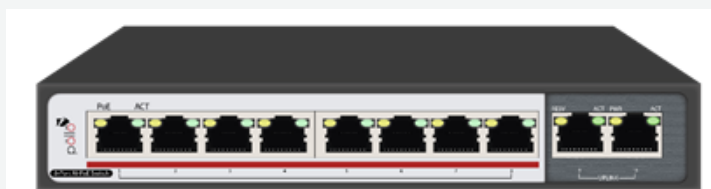

8-Port AI PoE Switch With 2GB Uplink PLN-1108MGB



Pollo Pty Ltd.

Address: Suite 401, 55 Phillips St. Parramatta, NSW 2150

Phone: 1300 6600 368

Email: info@pollo.net.au

Website: www.pollo.net.au





8-Port AI PoE Switch With 2GB Uplink (PLN-1108MGB)

Fast Ethernet Artificial Intelligence PoE Switch

- ✔ **AI Extend:** 1-8 port supports 250M meters long distance power supply (recommended cat 5 or above)
- ✔ **AI VLAN:** Isolating ports 1-8 from each other, restrain network storms effectively and improve network performance
- ✔ **AI QoS:** Prioritize the identified video data to make video transmission smoother
- ✔ **AI PoE:** Automatic detection power of port, power off and restart the device if find dead machine
- ✔ Support standard IEEE 802.3 af/at protocol, automatically detect and identify the PD devices comply with IEEE 802.3 af/at protocol and supply power.
- ✔ Support upward port auto MDI/MDIX.
- ✔ Adopted storage forward switching system.
- ✔ Smart power and minimum consumption, guarantee PD requirement.
- ✔ power supply circuit protection function and protection back-end device safety
- ✔ Automatically provide the adaptive device
- ✔ Fanless design realize saving energy and environment protection
- ✔ Compact size design
- ✔ Support saving power function when port dis-connection
- ✔ All Ports support Wire-speed forwarding capability
- ✔ Plug and play, easy using without configuration.



Description

PLN-1108MGB is a Gigabit uplink 8-port 100M PoE switch, it has three working modes, It has 4 working modes, AI VLAN mode, AI Extend video monitoring mode, AI PoE mode, AI QoS mode. All ports are free to communicate by default; In AI VLAN mode, 1 -8ports are isolated from each other, which can effectively restrain network storms and improve network performance. In AI Extend mode, the effective transmission distance of 1-8 ports can reach 250 meters, which is suitable for remote monitoring and power supply. In the AI power supply mode, the switch automatically detects the working status of the PD device and finds that the device abnormal automatically restarts the device. In AI QoS mode: the video data will be processed preferentially when the device is congested to make the video smoother PLN-1108MGB supports the standard IEEE 802.3 af/at protocol, which can automatically detect and identify the PD devices and supply power, therefore, Do not worry about PoE or non-PoE devices that can damage private standards.

Technical Specification

Product Name	8-Port AI PoE Switch With 2GB Uplink	
Product Model	PLN1108MGB	
Connector	8x 10/100M RJ45 Ports (MDI/MDIX auto sensing)	
	Max PoE power output is 30W. Total : 96W	
Transfer Mode	Transmission Distance: 250 Meters @10M, 100 Meters @ 100M	
	Store-And-Forward	
Network Medium	Twisted pair	
Performance Specification	Bandwidth: 5.6Gbps (no block)	
	Network latency (10 to 100Mbps) : maximum 20 μs (using 64 byte packet)	
Network Protocols and Standards	Buffer Memory:800Kbit MAC Size: 1K	
	MTBF: 50,000hours	
Switch Mode Definition	IEEE 802.3i 10BASET	
	IEEE 802.3u 100BASETX	
LEDs Status	IEEE 802.3x Flow Control	
	IEEE 802.3af/at Powe over Ethernet	
Power	AI VLAN	AI PoE
	AI EXTEND	AI Qos
Dimension	PWR	RESV
	L/A	PoE Indicator
Working Environment	Total Power : 60W	
	Single Port : 30W	
Radiation	184 * 94 * 27mm	
	Operating Temperature: 0 ° ~ 45 ° C;	
Safety	Storage Temperature: -20 ° ~ 90 ° C;	
	Humidity: 10% ~ 90%, non condensing	
Warranty	Storage Humidity: 5% ~ 95%, non-condensing;	
	Working Altitude: 3000 m (10,000 ft);	
	Storage Altitude: 3,000 m (10,000 ft)	
	CE	
	FCC	
	FCCI Class A	
	CE/ROHS/FCC/CCC4	
	1 year warranty	

Dimensions

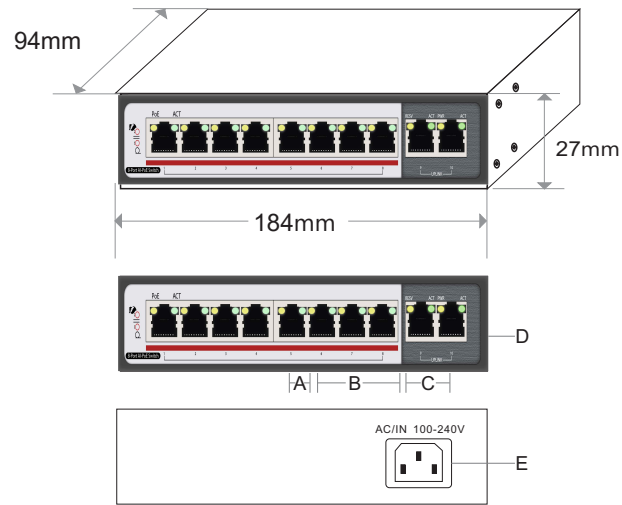

- A. Working Indicator B. 8x 100M PoE Ports
 C. 2x1000 Mbps Uplink Port D. Switch (Standard: 100m ; Extend: 250 m)
 E. AC100-240V,50/60Hz

Application

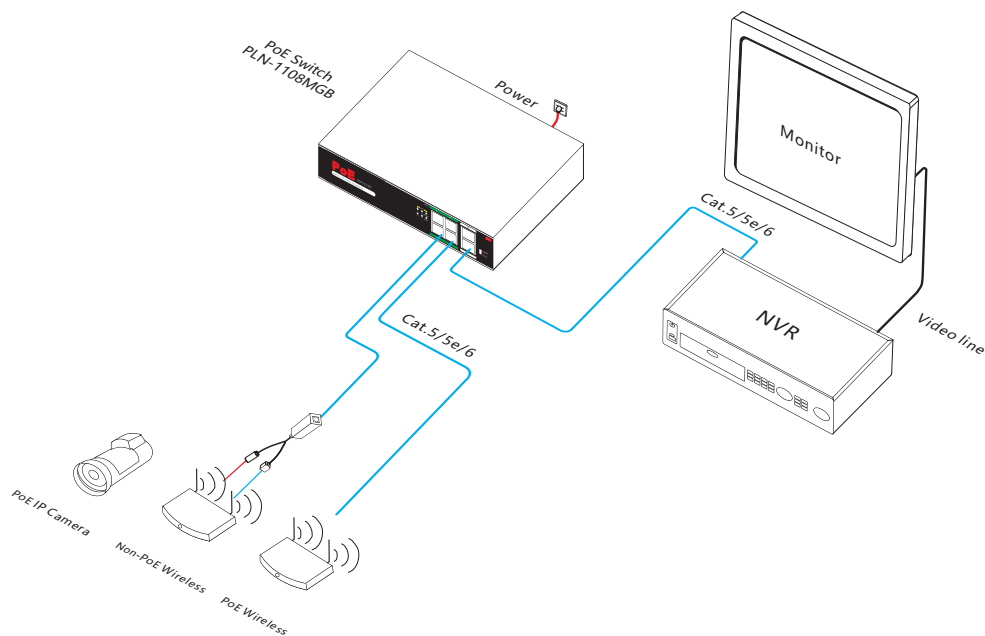

Ordering Information

Product Model: PLN1108MGB
Product Description: 8-Port 10/100M Standard PoE Switch. Port 1-8 support PoE function with port isolation function. IEEE802.3af/at, max PoE power output for each port is 30W. Total power is 96W. Long transmission distance at 250 meters for both power and data. Built-in power supply.

Packing List

Packing List	8-Port AI PoE Switch With 2GB Uplink
	Power Cable
	Mounting Kits
	User Guide
	Warranty Card