

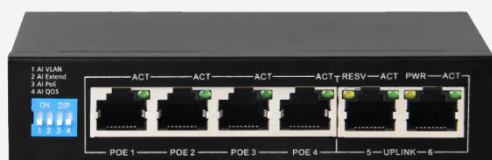

6-Port Gigabit AI PoE

PLN-1104GB



Pollo Pty Ltd.

Address: Suite 401, 55 Phillips St. Parramatta, NSW 2150

Phone: 1300 6600 368

Email: info@pollo.net.au

Website: www.pollo.net.au





6-Port Gigabit Artificial Intelligence, PoE Switch (PLN-1104GB)

Fast Ethernet Artificial Intelligence PoE Switch

- ✦ AI Extend: 1-4 ports support 250 meters long distance power supply (should use cat5e or cat6 cable)
- ✦ AI VLAN: Isolating ports 1-4 to each other can effectively suppress network storms and improve network performance.
- ✦ AI QoS: Prioritize the identified video data to make video transmission smoother
- ✦ AI POE: Automatically detect the power receiving port, find the dead device, power off and restart the device
- ✦ Support wireless access points (APs) and network surveillance cameras via Cat 5 cables;
- ✦ Support IEEE802.3af/at standard PD device
- ✦ Supports uplink port auto-flip (Auto MDI/MDIX)
- ✦ Adopt store-and-forward exchange mechanism
- ✦ Intelligent power supply, lowest power consumption, ensure the power demand of the PD terminal
- ✦ With power circuit protection, it can protect the security of the back-end equipment;
- ✦ Zero configuration feature power is automatically supplied to the adaptive device;
- ✦ No fan design to achieve energy saving and environmental protection;

Description

PLN1104GB is 6 port Gigabit AI PoE switch with 4 working modes, AI VLAN mode, AI Extend mode, AI power mode, AI QoS mode. By default, all ports are free to communicate; when AI VLAN mode is enabled, 1-4 ports are isolated from each other, which can effectively suppress network storms and improve network performance. In the AI Extend mode 1-4 ports can effectively transmit distances up to 250 meters, which is suitable for remote monitoring and power supply. In the AI power mode, the switch automatically detects the working status of the PD device and finds that the abnormal device automatically restarts the device. In the AI QoS mode, when the device is congested, the video data is processed preferentially to make the video smooth. The device supports the standard IEEE 802 af/at protocol, which can automatically detect and identify the PDs that comply with the IEEE 802 af/at standard and provide power for them, so there is no need to worry about PoE or non-PoE devices that can damage private standards.

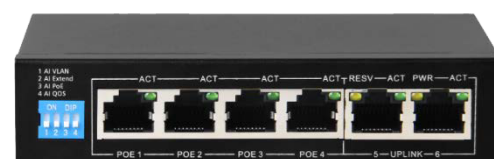

Technical Specification

Product Name	6-Port Gigabit Artificial Intelligence PoE Switch
Product Model	PLN1104GB
Connector	4 10/100Mbps PoE RJ45 port(MDI/MDIX auto sensing) Max Power Output; Single port: 30W Total : 60W Distance: Transmission Distance; 100m @ 100Mbps 250m @ 10Mbps
Transfer Mode	Store-And-Forward
Network Medium	Twisted pair
Performance Specification	Bandwidth : 12Gbps (no block) Network latency (100 to 100M bps) : maximum 20 μs (using 64 byte packet) Buffer Memory: 1Mbit MAC Size: 2K MTBF: 50000 hours
Network Protocols and Standards	IEEE 802.3i、 IEEE 802.3u、 IEEE 802.3x、 IEEE 802.3af、 IEEE 802.3at
Switch Mode Definition	AI VLAN AIPoE AI EXTEND AI Qos
LEDs Status	PWR RESV L/A PoE Indicator
Power	Total Power : 60W Singel Port : 30W
Dimension	142 * 113 * 40mm
Working Environment	Operating Temperature: 0℃~40℃ Storage Temperature: -40 ~70 ℃ Humidity: 10% ~ 90%, non condensing Storage Humidity: 5% ~ 90%, non-condensing; Working Altitude: 3000 m (10,000 ft); Storage Altitude: 3,000 m (10,000 ft)
Radiation	CE FCC FCCI Class A
Safety	CE/ROHS/FCC/CCCR
Warranty	1 year warranty

Dimensions

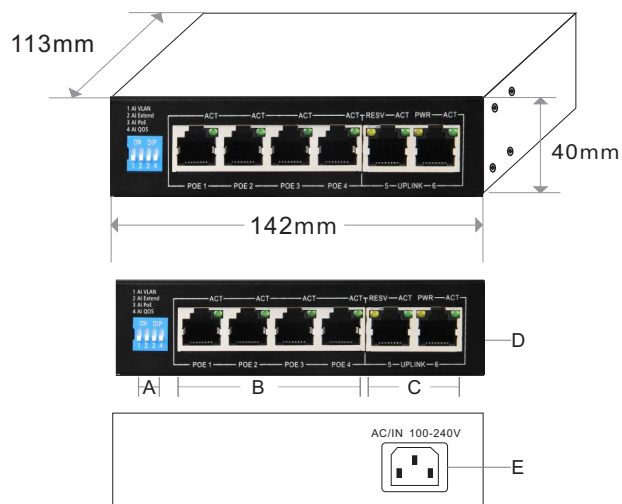

- A. Working Indicator B. 4x Gigabit PoE Ports
 C. 100M Uplink Port D. Switch (Standard: 100m ; Extend: 250m)
 E. AC100-240V, 50/60Hz

Application

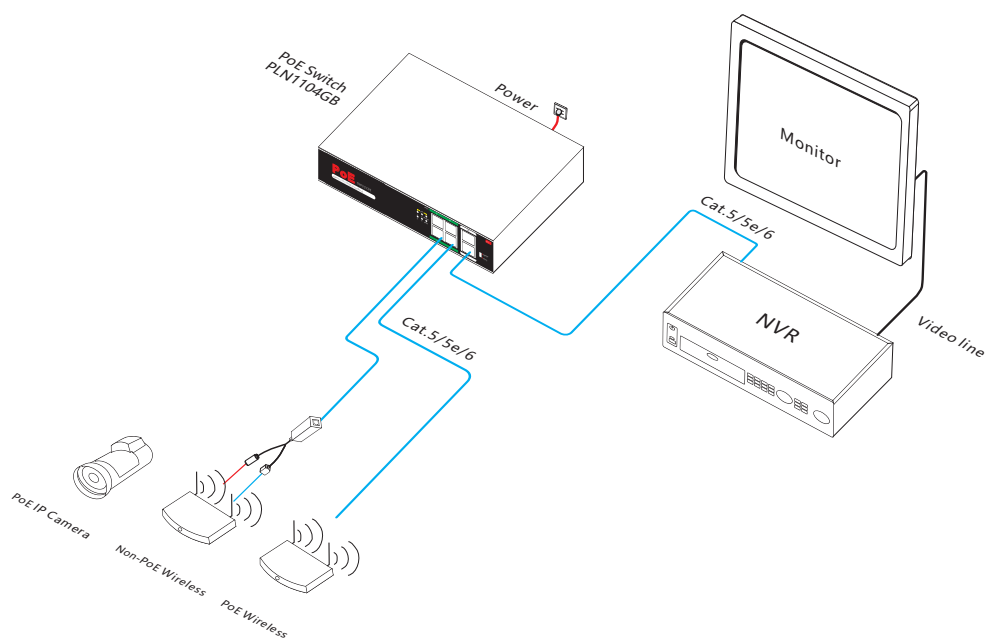

Ordering Information

Product Model: PLN1104GB

Product Description: 6-Port 10/100M Standard PoE Switch. Port 1-4 support PoE function with port isolation function. IEEE802.3af/at, max PoE power output for each port is 30W. Total power is 60W. Long transmission distance at 250 meters for both power and data. Built-in power supply.

Packing List

Packing List	6-Port Gigabit Artificial Intelligence PoE Switch
	Power Cable
	Mounting Kits
	User Guide
	Warranty Card